

Installing Phantom □16 traversing system

Dimensions for wall installation

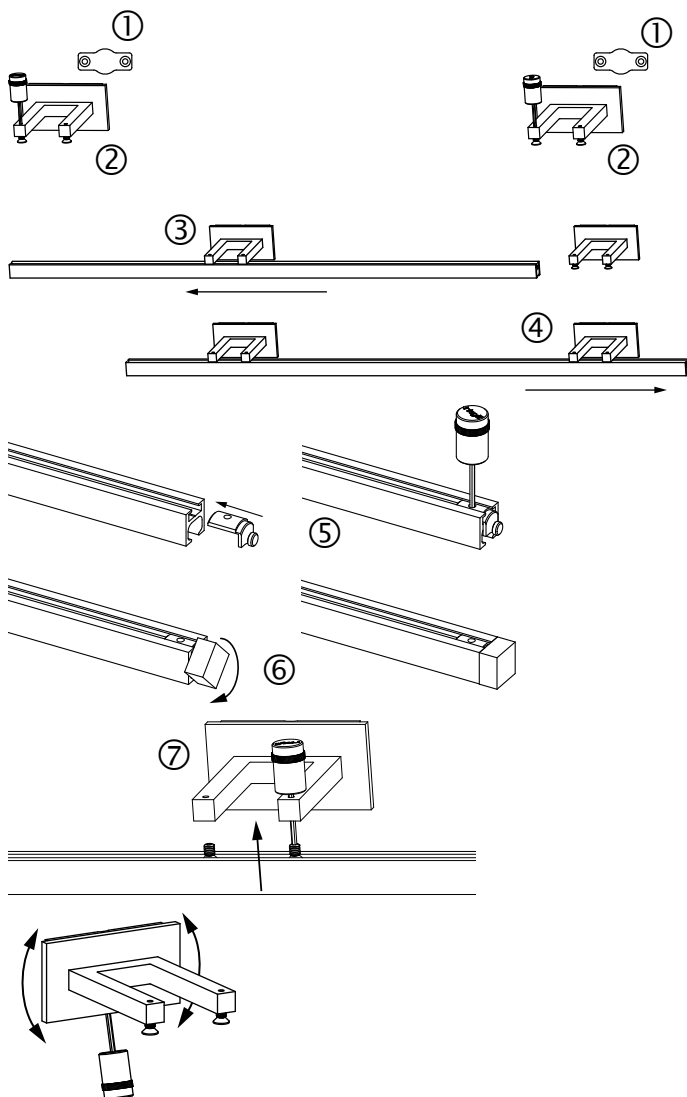
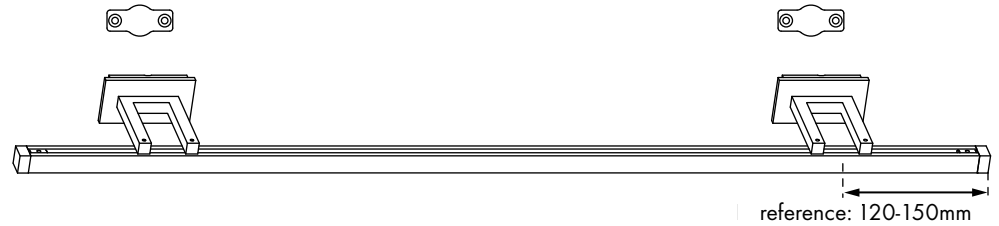
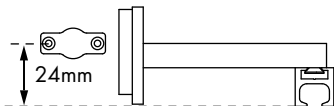

Träger ausrichtbar

Installation procedure

Without intermediate bracket

1. Attach both brackets to the wall ①
2. Generously loosen the screws using an Allen key ②
3. Slide the profile on one side ③
4. Then slide the profile on the other side, adjust ④ and screw tight
5. Fasten the profile insert ⑤ (not too tight!)
6. Align the finial (the profile insert is shifted) ⑥

With intermediate bracket

1. Attach all the brackets to the wall ①
2. Generously loosen the outer bracket screws using an Allen key ②
Unscrew the intermediate bracket screws
3. Insert the intermediate bracket screws into the profile and loosely screw into the intermediate bracket ⑦
4. Slide the profile in the outer brackets, adjust ③+④ and screw tight
5. Fasten the profile insert ⑤ (not too tight!)
6. Align the finial (the profile insert is shifted) ⑥

! Together with the wall socket, remove the screws from all the brackets and insert into the profile.

Assembly instructions
as video



Care Instructions

- Use the products in dry interior areas only.
- Remove dust deposits from time to time using a lightweight damp cloth.
- Do not use scouring agents, polish or cleaning products that contain solvents.

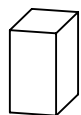

Phantom 1

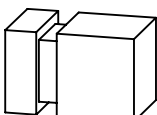

Phantom 2

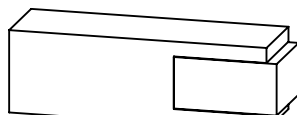

Phantom 3